

ONE BEDROOM

TYPE IB2P-G

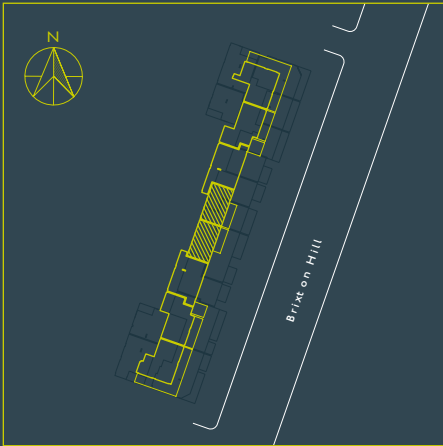

TOTAL AREA: 51.8m²/557.1ft²

APT
06.04
06.05

LVL
6 (handed)
6

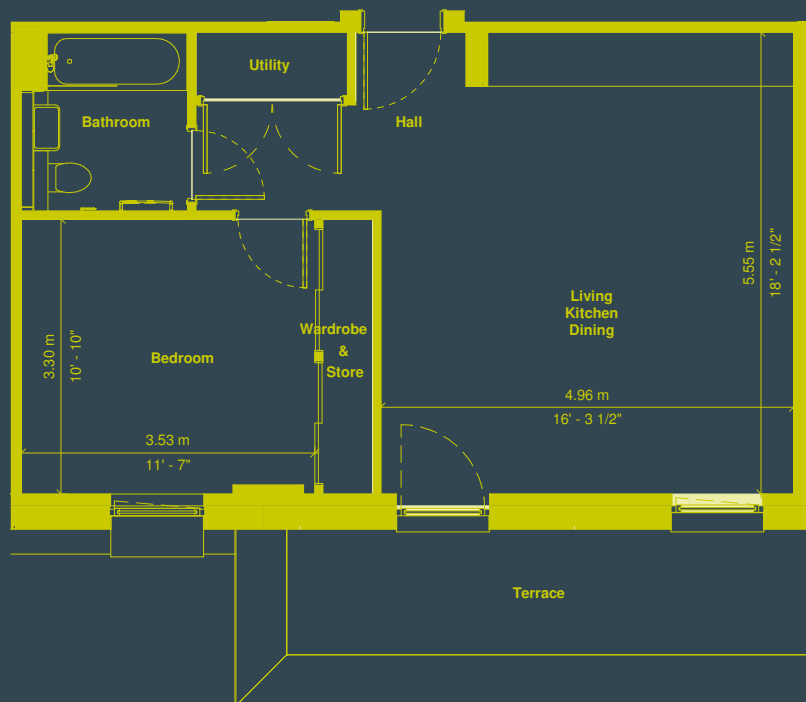

PLEASE NOTE THAT WINDOW, DOOR, BALCONY AND TERRACE CONFIGURATIONS MAY VARY DEPENDING ON PLOT. KITCHEN LAYOUTS ARE INDICATIVE ONLY. PLEASE CHECK WITH YOUR SALES ADVISOR FOR DETAILS.